

MSD – telephone silencer

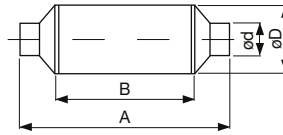

- silencer for a fixed pipe or a flexible pipe, it is mounted directly behind poppet valves or in places with a requirement to increase insertion attenuation
- limits transmission of voice band frequencies
- it is suitable for sanitary facilities, offices, etc., wherever there is undesirable transmission of noise through pipes
- total length of the shock absorber is 400 mm

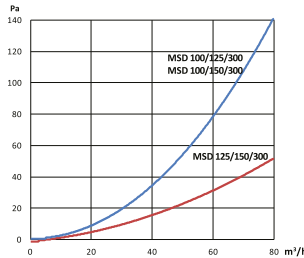

pressure loss

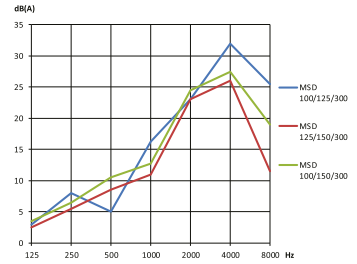

insertion attenuation

Type	A [mm]	B [mm]	Ø d [mm]	Ø D [mm]
MSD 100/125/300	400	300	100	125
MSD 100/150/300	400	300	100	150
MSD 125/150/300	400	300	125	150

SGD 100, SGD 125, SGD 150, SGD 160 – plug-in telephone silencer

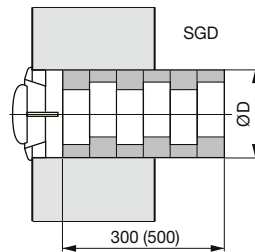

- plug-in silencer, which is simply inserted into the pipe behind the poppet valve
- limits transmission of voice band frequencies
- it is suitable for sanitary facilities, offices, etc., wherever there is undesirable transmission of noise through pipes

Type	Ø D [mm]	L [mm]
SGD 100/300	100	300
SGD 125/300	125	300
SGD 150/500	150	500
SGD 160/500	160	500

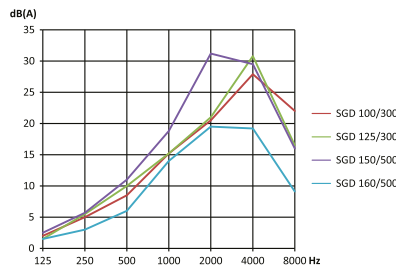

insertion attenuation

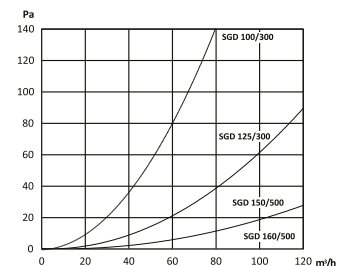

pressure loss

71