

IWG – rain blind

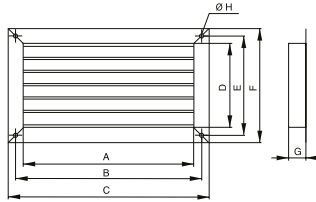

- for square pipes
- solid slanted slats
- material is galvanized sheet
- a net against the entry of small birds
- custom floor frame
- suitable for assembly units

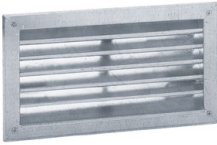
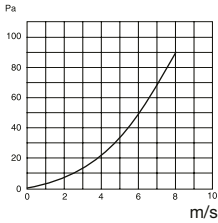

Type	fan IRB/IRT	piping dimensions	[mm]							weight [kg]	
			A	B	C	D	E	F	G		ØH
IWG 200/40-20	200	400×200	390	420	460	190	220	260	40	9	1.20
IWG 225/50-25	225	500×250	490	520	560	240	270	310	40	9	1.90
IWG 250/50-30	250	500×300	490	520	560	290	320	360	40	9	2.00
IWG 285/60-30	285	600×300	590	620	660	290	320	360	40	9	2.20
IWG 315/60-35	315	600×350	590	620	660	340	370	410	40	9	2.40
IWG 355/70-40	355	700×400	690	720	760	390	420	460	40	9	2.90
IWG 400/80-50	400	800×500	790	820	860	490	520	560	40	9	4.00
IWG 450/100-50	450	1,000×500	990	1,020	1,060	490	520	560	40	9	5.00

IDF – protective grid for IRB/IRT fans

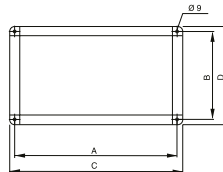
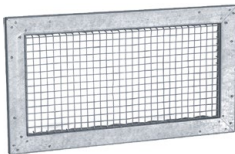

Type	piping size	[mm]			
		A	B	C	D
IDF 200	400×200	420	220	440	240
IDF 225	500×250	520	270	540	290
IDF 250	500×300	520	320	540	340
IDF 285	600×300	620	320	640	340
IDF 315	600×350	620	370	640	390
IDF 355	700×400	720	420	740	440
IDF 400	800×500	820	520	840	540
IDF 450	1,000×500	1,020	520	1,040	540

71

PT 489 – door grid

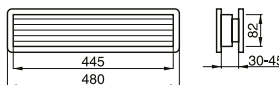

- installation in the cutout in the door leaf
- it consists of two parts, which are screwed together after sliding in from both sides of the door
- white (version B) or brown (version M) plastic design
- provides air supply to social facilities and other spaces
- dimensions of alternatively supplied grids on request